

## 181/150

≤54 B 10 11

≥76 B 10 12

### Lok 15° FF

15° Elbow FF

Bogen 15° II

Coude FF 15°

Curva 15° HH

Material: AISI 316L – 1.4404

O-ring: EPDM črn - black - Schwarz - noir - negro

ŠIFRA CODE	De	L mm	Z mm			
181015150	15	30	10	50	20	300
181022150	22	33	12	82	20	100
181028150	28	36	13	112	10	100
181035150	35	37	11	123	10	60
181042150	42	42	12	175	4	40
181054150	54	49	12	268	2	20
181076150	76,1	186	131	900	2	2
181088150	88,9	211	147	1250	2	2
181108150	108	247	169	1700	2	2

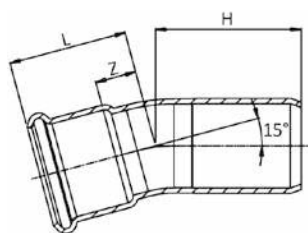

## 181/151

≤54 B 10 11

≥76 B 10 12

### Lok 15° M/Ž

15° Elbow MF

Bogen 15° IA

Coude MF 15°

Curva 15° HM

Material: AISI 316L – 1.4404

O-ring: EPDM črn - black - Schwarz - noir - negro

ŠIFRA CODE	De	L mm	H mm	Z mm			
181015151	15	30	40	10	50	20	300
181022151	22	33	41	12	82	20	100
181028151	28	36	43	13	112	10	100
181035151	35	37	41	11	133	10	60
181042151	42	42	47	12	195	4	40
181054151	54	49	55	13	293	2	20
181076151	76,1	186	194	131	900	2	2
181088151	88,9	211	219	147	1250	2	2
181108151	108	247	256	169	1700	2	2

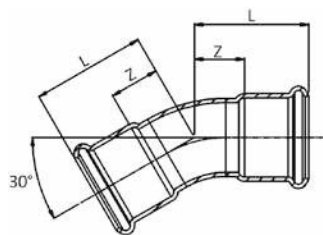

### 181/300

≤54 B 10 11

≥76 B 10 12

#### Lok 30° Ž/Ž

30° Elbow FF

Bogen 30° II

Coude FF 30°

Curva 30° HH

Material: AISI 316L – 1.4404

O-ring: EPDM čern - black - Schwarz - noir - negro

ŠIFRA CODE	De	L mm	Z mm			
181015300	15	33	13	50	20	300
181022300	22	37	16	82	20	100
181028300	28	41	18	112	10	100
181035300	35	37	11	123	10	60
181042300	42	44	14	175	4	40
181054300	54	52	17	268	2	20
181076300	76,1	100	55	900	2	2
181088300	88,9	115	64	1250	2	2
181108300	108	127	68	1700	2	2

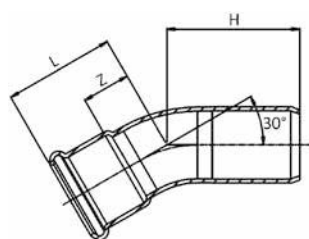

### 181/301

≤54 B 10 11

≥76 B 10 12

#### Lok 30° M/Ž

30° Elbow MF

Bogen 30° IA

Coude MF 30°

Curva 30° HM

Material: AISI 316L – 1.4404

O-ring: EPDM čern - black - Schwarz - noir - negro

ŠIFRA CODE	De	L mm	H mm	Z mm			
181015301	15	33	43	13	50	20	300
181022301	22	37	46	16	82	20	100
181028301	28	41	48	18	112	10	100
181035301	35	37	46	11	133	10	60
181042301	42	44	54	14	195	4	40
181054301	54	52	63	17	293	2	20
181076301	76,1	100	108	55	900	2	2
181088301	88,9	115	123	64	1250	2	2
181108301	108	127	136	68	1700	2	2

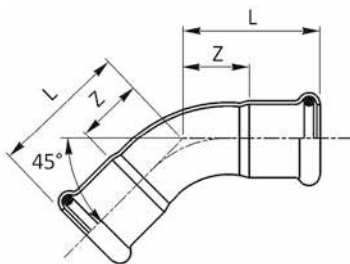

### 181/450

≤54 B 10 11

≥76 B 10 12

#### Lok 45° Ž/Ž

45° Elbow FF

Bogen 45° II

Coude FF 45°

Curva 45° HH

Material: AISI 316L – 1.4404

O-ring: EPDM črn - black - Schwarz - noir - negro

ŠIFRA CODE	De	L mm	Z mm	g		
181015450	15	36	16	50	20	300
181018450	18	37	17	64	20	300
181022450	22	41	20	82	20	100
181028450	28	47	24	112	10	100
181035450	35	43	17	127	10	60
181042450	42	51	21	177	4	40
181054450	54	62	30	273	2	20
181076450	76,1	131,5	76,5	900	2	2
181088450	88,9	144	84	1250	2	2
181108450	108	169	94	1700	2	2

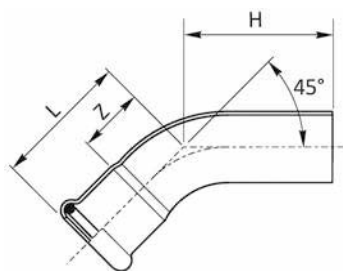

### 181/451

≤54 B 10 11

≥76 B 10 12

#### Lok 45° M/Ž

45° Elbow MF

Bogen 45° IA

Coude MF 45°

Curva 45° HM

Material: AISI 316L – 1.4404

O-ring: EPDM črn - black - Schwarz - noir - negro

ŠIFRA CODE	De	L mm	H mm	Z mm	g		
181015451	15	36	49	16	50	20	300
181018451	18	37	43	17	64	20	300
181022451	22	41	48	20	82	20	100
181028451	28	47	54,5	22	112	10	100
181035451	35	43	57,7	17	132	10	60
181042451	42	51	72	21	196	4	40
181054451	54	62	82	26	296	2	20
181076451	76,1	131,5	149	76,5	900	2	2
181088451	88,9	144	159	84	1250	2	2
181108451	108	169	199	94	1700	2	2

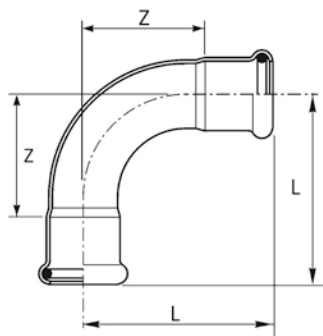

### 181/900

≤54 B 10 11

≥76 B 10 12

#### Lok 90° Ž/Ž

90° Elbow FF

Bogen 90° II

Coude FF 90°

Curva 90° HH

Material: AISI 316L – 1.4404

O-ring: EPDM črn - black - Schwarz - noir - negro

CODE	De	L mm	Z mm			
181015900	15	50	30	58	20	300
181018900	18	54	34	72	20	200
181022900	22	60	39	102	10	100
181028900	28	73	50	143	10	50
181035900	35	68	42	162	5	50
181042900	42	80	50	231	2	30
181054900	54	100	64	367	2	18
181076900	76,1	160	105	1150	2	2
181088900	88,9	182	122	1580	2	2
181108900	108	220	145	2250	2	2

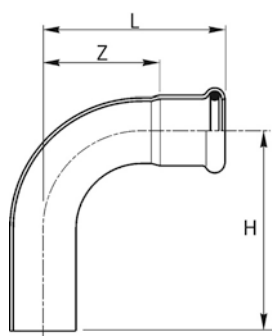

### 181/901

≤54 B 10 11

≥76 B 10 12

#### Lok 90° M/Ž

90° Elbow MF

Bogen 90° IA

Coude MF 90°

Curva 90° HM

Material: AISI 316L – 1.4404

O-ring: EPDM črn - black - Schwarz - noir - negro

ŠIFRA CODE	De	L mm	H mm	Z mm			
181015901	15	50	63	30	58	20	300
181018901	18	54	63	34	72	20	200
181022901	22	60	71	39	102	10	100
181028901	28	73	81	50	143	10	50
181035901	35	68	82	42	176	5	50
181042901	42	80	101	50	253	2	30
181054901	54	100	120	64	390	2	18
181076901	76,1	160	180	105	1150	2	2
181088901	88,9	182	197	122	1580	2	2
181108901	108	220	236	145	2250	2	2

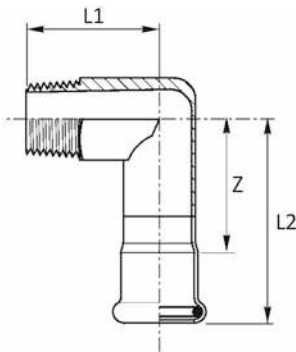
**197**
**Lok zunanji navoj 90° moški spoj**

Elbow adapter 90° with male thread

Übergangswinkel 90° AG

Equerre 90° avec filetage M

Codo macho

Material: AISI 316L – 1.4404

O-ring: EPDM črn - black - Schwarz - noir - negro

Filettatura: EN 10226-1 (ex ISO 7/1)

ŠIFRA CODE	De x R mm x inch	L1 mm	L2 mm	Z mm			
197102015	15 x 1/2"	37	57	37	94	10	200
197102018	18 x 1/2"	37	57	38	105	10	200
197102022	22 x 1/2"	39	58,5	37,5	149	10	100
197304022	22 x 3/4"	39	61	40	149	10	100
197100028	28 x 1"	44	68	45	246	5	50
197114035	35 x 1 1/4"	49	75	49	378	5	40
197112042	42 x 1 1/2"	54	84	54	468	2	30
197200054	54 x 2"	60	95	60	720	2	20

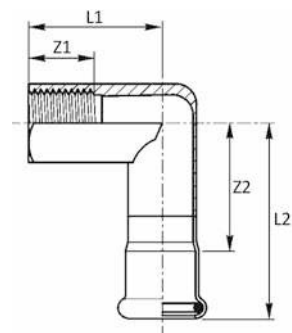
**198**
**Lok zunanji navoj 90° ženski spoj**

Elbow adapter 90° with female thread

Übergangswinkel 90° IG

Equerre 90° avec filetage F

Codo hembra

Material: AISI 316L – 1.4404

O-ring: EPDM črn - black - Schwarz - noir - negro

Filettatura: EN 10226-1 (ex ISO 7/1)

ŠIFRA CODE	De x Rp mm x inch	L1 mm	L2 mm	Z1 mm	Z2 mm			
198102015	15 x 1/2"	38	57	15	37	104	10	200
198304015	15 x 3/4"	34	38	15	18	110	10	200
198102018	18 x 1/2"	39	58	15	38	120	10	200
198102022	22 x 1/2"	41	58,5	15	37,5	172	10	100
198304022	22 x 3/4"	46	61	19	40	172	10	100
198102028	28 x 1/2"	44	62	15	39	200	5	50
198100028	28 x 1"	54	68	19	45	304	5	50
198114035	35 x 1 1/4"	63	75	21	49	420	5	40

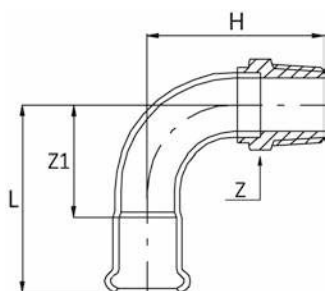
**186**

**Lok 90° BSP**  
 90° Elbow BSP  
 Bogen 90° mit AG  
 Coude 90° avec filetage M  
 Codo a 90° MF

Material: AISI 316L – 1.4404  
 O-ring: EPDM črn - black - Schwarz - noir - negro  
 Filettatura: EN 10226-1 (ex ISO 7/1)

ŠIFRA CODE	De x R mm x inch	L mm	Z mm	Z1 mm	H mm			
186102015	15 x 1/2"	50	24	30	54	56	20	300
186102018	18 x 1/2"	54	24	34	59	70	20	200
186304022	22 x 3/4"	60	30	39	69	92	10	100
186100028	28 x 1"	73	36	50	80	133	10	50
186100035	35 x 1"	68	41	42	85	277	5	50
186114035	35 x 1 1/4"	68	46	42	89	324	5	40
186114042	42 x 1 1/4"	80	50	50	107	438	2	20
186112042	42 x 1 1/2"	80	55	50	107	340	2	20
186200054	54 x 2"	100	65	65	141,5	515	2	12

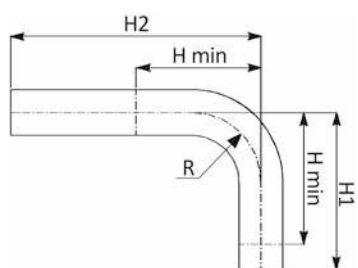
**194/900**

**Lok 90° M/M**  
 90° Elbow MM  
 Passbogen 90°  
 Coude d'ajustement 90°  
 Tubo ricurvo 90° MM  
 Material: AISI 316L – 1.4404

ŠIFRA CODE	De	H1 mm	H min mm	H2 mm	R mm			
194015900	15	70	48	120	35	60	20	160
194018900	18	70	53	120	38	68	20	160
194022900	22	70	61	120	40	108	10	100
194028900	28	97	80	125	45	150	10	50
194035900	35	120	90	200	54	362	4	20
194042900	42	160	115	250	76	530	2	10
194054900	54	200	140	305	97	886	2	10

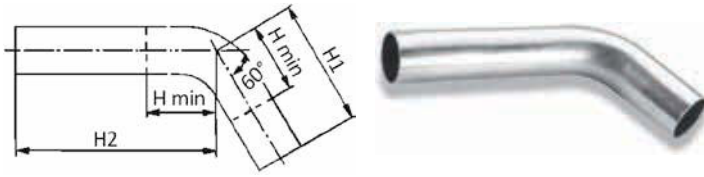

### 194/600

**Loki M/M spoj 60°**  
 60° Elbow MM  
 Passbogen 60°  
 Coude d'ajustement 60°  
 Tubo ricurvo 60° MM  
 Material: AISI 316L – 1.4404

ŠIFRA CODE	De	H1 mm	H min mm	H2 mm			
194028600	28	71	64	116	145	10	50
194035600	35	101	71	226	380	4	24
194042600	42	124	80	251	533	2	10
194054600	54	162	97	308	920	4	4

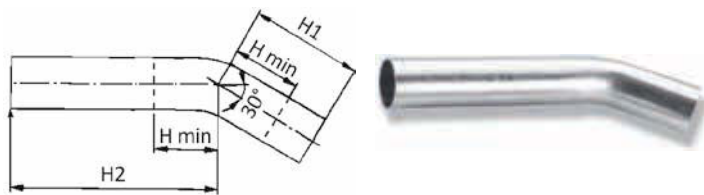

### 194/300

**Loki M/M spoj 30°**  
 30° Elbow MM  
 Passbogen 30°  
 Coude d'ajustement 30°  
 Tubo ricurvo 30° MM  
 Material: AISI 316L – 1.4404

ŠIFRA CODE	De	H1 mm	H min mm	H2 mm			
194028300	28	54	47	130	148	10	50
194035300	35	80	50	218	372	4	24
194042300	42	98	54	274	540	2	10
194054300	54	137	72	324	928	4	4

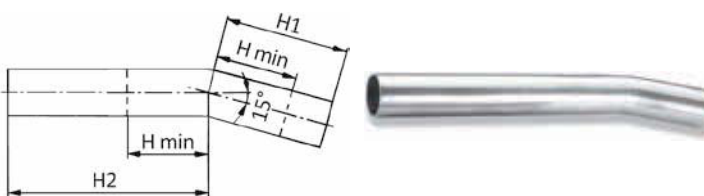

### 194/150

**Loki M/M spoj 15°**  
 15° Elbow MM  
 Passbogen 15°  
 Coude d'ajustement 15°  
 Tubo ricurvo 15° MM  
 Material: AISI 316L – 1.4404

ŠIFRA CODE	De	H1 mm	H min mm	H2 mm			
194028150	28	45	38	136	137	10	50
194035150	35	62	32	234	380	4	24
194042150	42	94	50	276	536	2	10
194054150	54	117	52	337	930	4	4